

The background of the entire page is a dark, monochromatic marbled paper pattern. The marbling consists of intricate, swirling, and cell-like shapes in various shades of dark gray and black, creating a complex, organic texture. The overall effect is reminiscent of traditional stone or shell marbling techniques.

Marta Sitarz

Graduate Portfolio



Refractions

Immersive performance concept
The Loco Klub
Written by Max Kyte

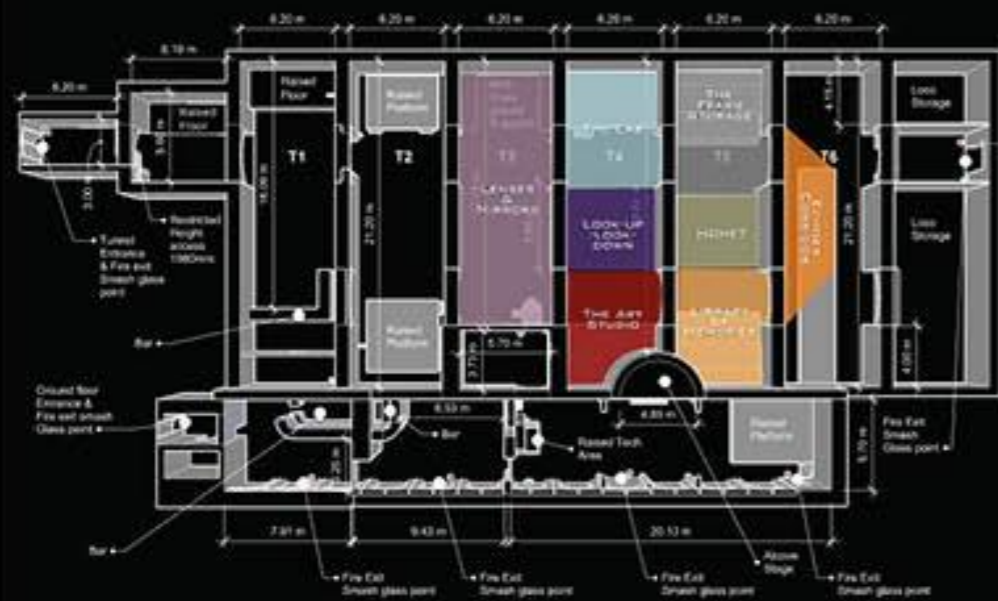

a free to roam immersive interactive environment where numerous storylines interlace across multiple rooms inhabited by vibrant characters, each of whom exists as an inseparable whole with their surroundings



The Doctor's Lab

science leads the way through this room, but could it feel like a trap to exist in a world of pure logic



The Artist's Studio

a dream world of light and poetry where the ignorance of beauty may come at a price



The Hidden Home

here peace and lack of responsibility come at a simple cost when everything outside is much more demanding

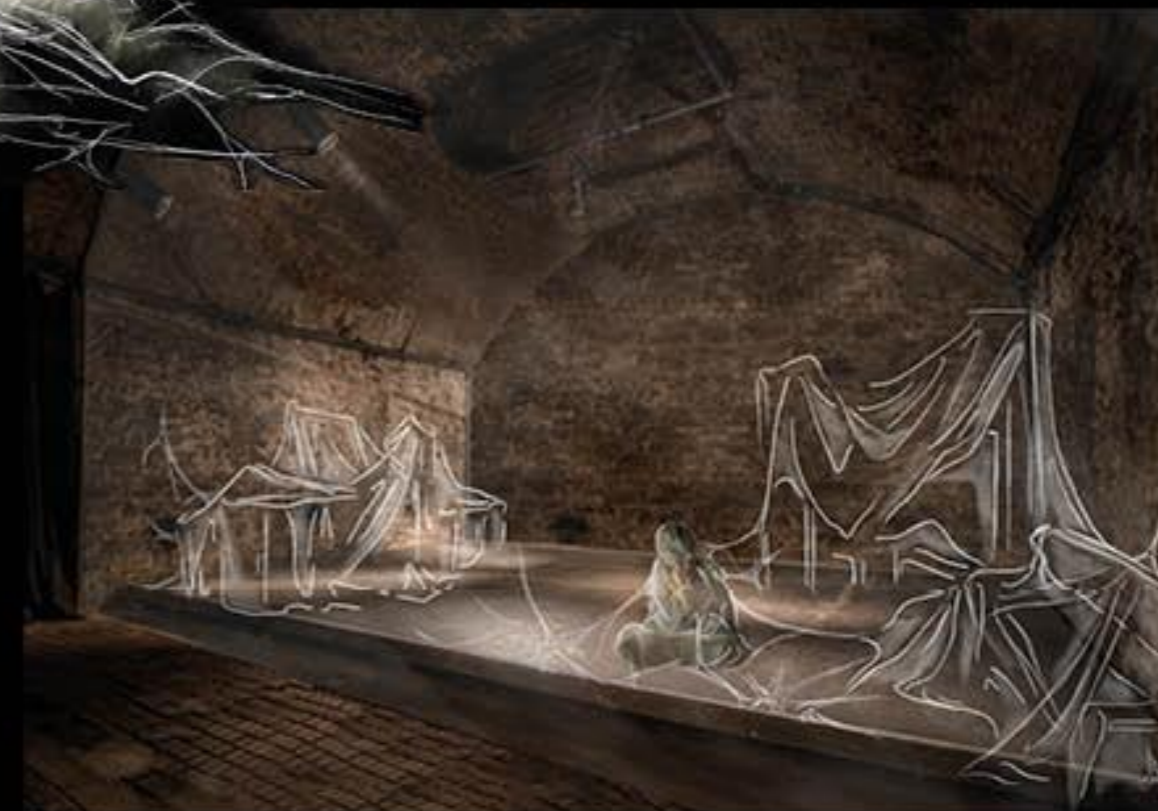



set acting as a visual representation of the Writer's personal world of thoughts and ideas being constrained and manipulated into imposed frames



Set and costume concept
Bristol Old Vic Theatre
Directed by Lydia Cook

The Writer



This House



Set design
Tobacco Factory Theatres
Directed by Nik Partridge

dynamic transformative set manipulated by the cast to establish a broad variety of settings, supported by projections displayed on the life-sized Westminster Clock centerpiece



realised set



1:25 scale model





The Brink

Set and costume design
The Wardrobe Theatre
Directed by Daniel Preciado



a psychological thriller in which the character's surroundings reflect his emotional state



as the story progresses the seemingly naturalistic elements become increasingly abstract, breaking apart as the central character loses his grip on reality and gradually slips into insanity





martaxsitarz.com
design@martaxsitarz.com



@cryptidart